

GEISSELE[®]

AUTOMATICS

We Manufacture Confidence[®]

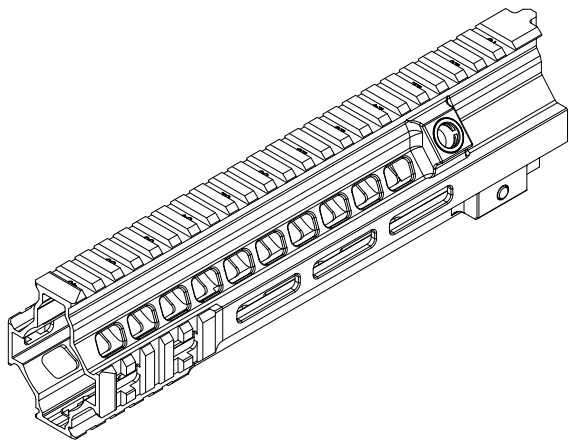

SUPER MODULAR RAIL HK-416 MK15 10.5" M-LOK Installation Instructions

Firearm safety is **YOUR** responsibility. You must memorize and put into practice the 4 Rules of Firearm Safety:

- 1. ASSUME EVERY WEAPON IS LOADED.**
- 2. KEEP YOUR FINGER OFF THE TRIGGER UNTIL YOU ARE READY TO SHOOT.**
- 3. DO NOT LET THE MUZZLE POINT AT ANYTHING YOU ARE NOT WILLING TO DESTROY.**
- 4. KNOW YOUR TARGET AND WHAT IS BEYOND.**

HK416 DESCRIPTION

The Super Modular Rail HK416 MK15 10.5" MLOK was designed to replace the standard rail on an HK416 or MR556 weapon platform. The rail system utilizes the stock HK barrel nut, but incorporates the strength, rigidity and modularity expected of a Geissele product. Made from 6061-T6 aluminum and finished in type 3 hardcoat anodize, the HK416 MK15 meets military specifications.

Featuring MLOK mounting options at the 3, 6 and 9 o'clock positions, as well as featuring a full picatinny rail along the top and shortened picatinny rails on the forend. The Geissele HK416 MK15 10.5 is trusted by our Nation's elite warfighters, and their input was taken into consideration while developing the feature and performance rich HK416 MK15.

INSTALLATION INSTRUCTIONS

The Geissele Super Modular Rail is easy to install. However, it will need some specialized tools that you may not have. Installation by a certified gunsmith is recommended. Essentially, the stock HK rail is removed in the normal manner, sling loops removed and the Geissele rail slid on just like the stock rail.

1. Make sure weapon is unloaded. Remove the HK rail according to the HK manual. If the weapon is an MR556 proceed to step 3.
2. If the upper is a HK416 (not an MR556) the sling loops on the outside of the gas block will need to be removed. The gas block is made from hard and tough steel and the loop material will not cut easily with a saw. We recommend this procedure be done by a certified and professional gunsmith/armorer using an industrial sander to sand the loops near flush.
3. Slide the MK15 handguard (Item 1) onto the stock HK barrel nut. Be very careful when doing this as the clearance between the OD of the barrel nut and ID of the handguard is precisely machined to about 0.001" clearance. Burrs or dings on the barrel nut will not allow the handguard to slide freely. It is recommended to lightly coat the barrel nut OD and ID of the handguard with a light film of oil before installing until you get the hang of installation. Slide the handguard against the barrel nut, and then use your fingers to align the other end of the handguard concentric to the barrel so the rail section is not cocked. By wiggling the handguard very slightly and pressing downward it will start on the barrel nut. Once it is about 1/2" onto the barrel nut it can be slid home. Do not force the handguard onto the barrel nut. If force is needed there is something wrong. Remove the handguard and inspect the OD and ID interface.
4. Install the rail mounting bolt. You may have to slightly slide the handguard to line up the hole with the groove in the barrel nut in order for the bolt to start. Once the bolt starts and turns a couple of revolutions it will become stiff to turn. The steel insert into which the bolt threads tighten is a locking insert, which means they will grip the bolt threads with a prevailing torque and prevent loosening or backing out of the bolt.
5. Tighten the rail mounting bolt to approximately 10 ft-lbf. The head of the bolts is sized for a 12 point 3/8" socket or wrench, or the wrench of a Leatherman[®] MUT multitool. In a pinch the lug of the weapon locking bolt can be used in the cross imbedded in the bolt head. If a torque wrench is not available or when using the bolt carrier assembly use your best tightening judgment but do not over tighten. Note the stock HK bolt can be used in place of the Geissele bolt.

UTILIZING THE M-LOK ATTACHMENT SYSTEM

The HK416 MK15 10.5" M-LOK has been designed using Magpul's advanced M-LOK modular locking accessory mounting system. This system allows the user to easily add or remove accessories based on mission requirements using a 1/8" hex key. Be sure to read the instructions below carefully, improper installation may cause permanent damage to your rail that is not covered by the Geissele warranty.

6. To install make sure the nut is started onto the bolt with at least 1 full thread showing out the back of the nut (**Figure 1**). If one full thread is not showing, there is a chance that the M-LOK nut will not cam into the M-LOK

slot properly. If this occurs and the screw is tightened, the M-LOK nut can pull through the rail leaving a gash in the rail and causing a burr in the surface.

- Align the nut with the recoil lugs so they pass through the M-LOK slots (**Figure 2**).
- Begin to tighten the bolt one full turn with the hex key. The cammed nut will rotate, tighten, and eventually lock into place retaining the accessory on the handguard. Additional torque can be applied to hold the accessory in place (**Figure 3**).
- Removing the accessory requires 1 turn counter clockwise. The cammed nut will align with the recoil lugs on the accessory allowing the accessory to come off the rail. Care should be taken to not remove the nut from the bolt or M-LOK accessory. Loosening the screw further than 1 turn may result in permanent damage to the rail.

Figure 2

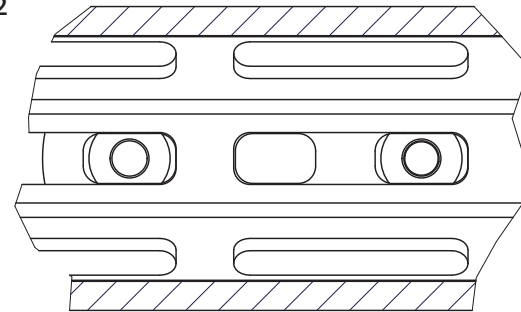

Detail view showing the camming M-LOK nut unlocked and ready to insert or remove the accessory.

Figure 1

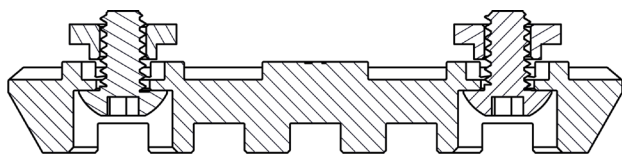

Thank You For Your Purchase.
Contact Geissele Automatics with any questions.

GEISSELE AUTOMATICS • 800 NORTH WALES RD • NORTH WALES, PA 19454

TEL: 610.272.2060 | **FAX:** 610.272.2069

E-MAIL: SALES@GEISSELE.COM | **WEB:** WWW.GEISSELE.COM

HK416 MK15 10.5" M-LOK INSTRUCTIONS, V1 -05/2020

Figure 3

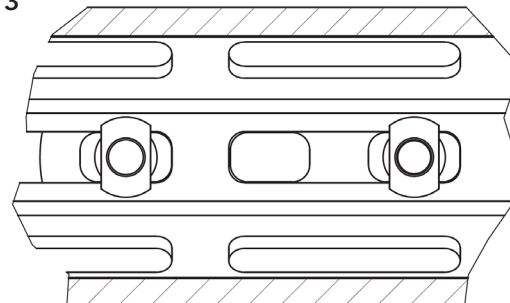

Detail view showing the camming M-LOK nuts locked in place to retain the accessory.

